

\$ 79,900

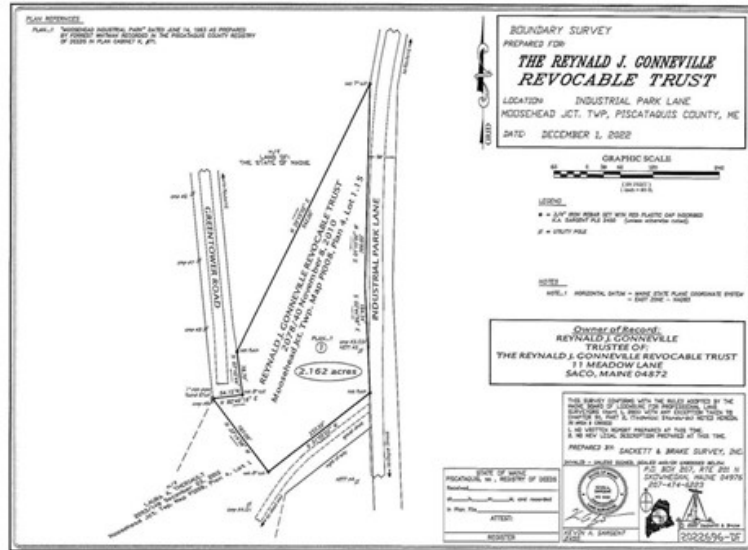

Mpi8 L4-115 Industrial Park Rd, Greenville, ME 04441

- » MLS #: 1633036
- » Land | Lot: 91,476 ft² (2.1 acres)
- » More Info: Mpi8L4-115IndustrialParkRd.IsForSale.com



Ernie Falcone

(207) 612-1488

erniefalcone@kw.com

<https://erniefalcone.kw.com/>



Keller Williams Realty

50 Sewall Street

Portland, ME 04102

(207) 879-9800

Remarks

Don't miss this exceptional 2.1 acre commercial lot located in the heart of Maine's four-season recreational region. With excellent road frontage and high visibility the lot offers endless possibilities for development, whether you're envisioning retail, hospitality, storage, or service based business. Just minutes from Moosehead Lake, the area's top destination for tourism and outdoor adventure, this site benefits from consistent traffic year-round. Utilities are available at the roadside, and the lot provides ample space for parking or expansion. A rare chance to secure a strategic location in one of Maiane's most scenic and growing communities.

